

## VOLANS TUNABLE WHITE

Product Code **DT. Volans Dynamic 24v** (add suffix see below)

IP20 or IP54 zone 2 **CE** **LED** IEE : A+ EN 60598.

DESCRIPTION / Linear flexible LED strip, 10mm wide. IP20 or invisible Dow Corning resin coated IP54

Dimensions (mm)  
4 (h) x 10 (width)

WHY USE THIS: Versatile (SMT) LED of high quality CRI90 and high performance. Very close pitch allows for 40mm cutting centres. Ideal for long runs. Fully dimmable and matched with many profiles suitable for all genral lighting applications. Including wet areas.

Cut-out (mm)  
N/A

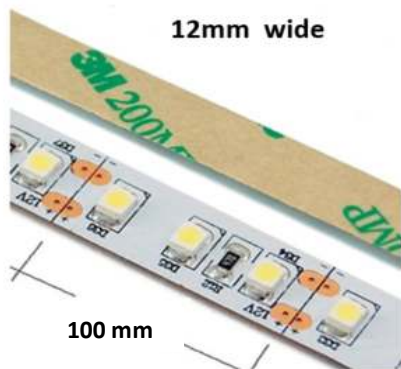

20MM PITCH, CUTTING CENTRES 100MM



Contact us for the range of profiles

<b>material light fixture</b>	PVC / plastic mix; copper conductors 4oz
<b>colours &amp; finish/ (suffix)</b>	Clear
<b>light source &amp; voltage options</b> (PLEASE CONTACT US FOR ALTERNATIVE SOURCES)	a) (3014) 19W/m LED 140deg (700 lms/colour/m) 24v DC b) c) d)
	120 LEDs/m
<b>colour temperature /(suffix)</b>	<b>One channel 2700k, one channel 5000k</b>
<b>CRI (colour render) /(suffix)</b>	>80
<b>MacAdam</b>	3
<b>Controls options /(suffix)</b>	DMX DALI 0-10V
<b>Optional Accessories</b>	See p.2 for available profiles See p.3-4 for driver options
<b>AV. Weight (kg)</b>	0.04/m
<b>Emergency Available?</b>	Yes
<b>Special Notes</b>	<b>Supplied with 1m attached 'power-lead'. <a href="#">Cutting and soldering service available. Supplied with 3m tape as standard</a></b>

### technical performance

height(m)	Φ(m)	lux levels
1m	3.46m	268lx (max)
2m	6.92m	74lx (max)
3m	10.39m	34lx (max)
4m	13.89m	19lx (max)



contact Detail lighting for all .ies files

# PROFILES FOR VOLANS 10MM WIDE

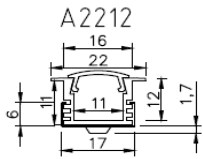

For routing joinery

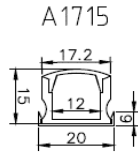

General purpose - can be trimless

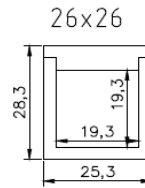

Outdoor sealed

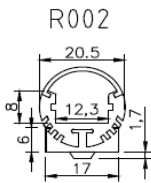

16x18mm

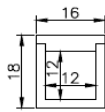

Sealed wet areas

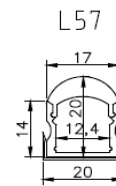

Lensed for partial wall washing

Pivoting mount for A1715



Coffers & shadow gap

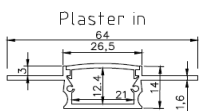

Trimless. Detail

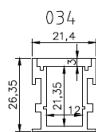

Outdoor walk over sealed.

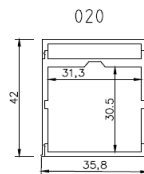



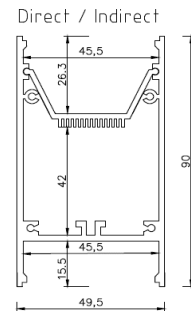

Any length Ceiling surface commercial (suspended available)



Any length  
Suspended Commercial

## DRIVER OPTIONS DRIVER + DIMMING INTERFACE OPTIONS

Image	Code	dims	IP rating	Power	Inrush	Comment
	<b>DT.HLG-600-24</b>	230 X 127 X 40.5mm	IP65	600w	70A	For dimming use with MULTIPLE DT.ECP-701-8A below (additional in-rush current limiter available)
	<b>DT.HLG-320</b>	252 X 69 X 45MM	IP67	320w	70A	POTENTIOMETER BUILT-IN For dimming use with MULTIPLE DT.ECP-701-8A below (additional in-rush current limiter available)
	<b>DT.HLG-240</b>	247 X 69 X 39MM	IP67	240w	75A	POTENTIOMETER BUILT-IN For dimming use with MULTIPLE DT.ECP-701-8A below (additional in-rush current limiter available)
	<b>DT.SL-24200D02</b>	235 X 120 X 56MM	IP67	200w	75A	For dimming use with DT.ECP-701-8A below 2-CHANNELS OF 100W
	<b>DT.SL-24150D02</b>	235 X 120 X 56MM	IP67	150w	65A	For dimming use with DT.ECP-701-8A below
	<b>DT.SL-24100D02</b>	249 X 66 X 52MM	IP67	100w	60A	For dimming use with DT.ECP-701-8A below
	<b>DT.SL-VB-240-60I</b>	199 X 66 X 52MM	IP67	60w	55A	For dimming use with DT.ECP-701-8A below
	<b>DT.SL-VB-240-30I</b>	222x 29 x 20	IP67	30w	40A	For dimming use with DT.ECP-701-8A below
	<b>DT.SL-VA-240-15I</b>	222x 29 x 20	IP67	20w	35A	For dimming use with DT.ECP-701-8A below
	<b>DT.ECP-701-8A</b>	82 x 33 x 20mm	IP20	200W MAX 0-10V DIMMING INTERFACE		DIMS DOWN <10% FROM ZERO
	<b>DT.ECP-701-12A</b>	175 x 44 x 33	IP20	200W MAX 0-10V DIMMING INTERFACE		DIMS DOWN <10% FROM ZERO

## DRIVER OPTIONS (continued)



**DT.ECP-701-8A-**  
**DALI** 158x 50.5x 34  
**(DUAL OPERATION)**

IP20

200W MAX DALI DIMMING INTERFACE  
200W MAX DMX DIMMING INTERFACE